

H5011 | H5012 | H5013 H5014 | H5015 | H5016

GB | GoSmart Scene Switch



Contents

Safety Instructions and Warnings	2
Package Contents	3
Technical Specifications	3
Device Description	4
Installation and Assembly	5
Controls and Functions	9
Troubleshooting FAQ	11

Safety Instructions and Warnings



Read the user manual before using the device.



Follow the safety instructions in the manual.

EMOS spol. s r.o. declares that products H5011, H5012, H5013, H5014, H5015, H5016 conform to the basic requirements and other applicable provisions of relevant directives. The device can be freely operated in the EU.

The Declaration of Conformity can be found at <http://www.emos.eu/download>.

The device can be operated on the basis of general authorization no. VO-R/10/07.2021-8, as amended.





Package Contents

Smart scene switch
User manual
2× double-sided tape

Technical Specifications

Power supply: CR2430 3 V
Dimensions: 86 × 86 × 13 mm
Communication protocol: ZigBee 3.0
(2,402~2,480 MHz)
EIRP: 5.05 dBm
Operating range: 25 m (open space)
Operating temperature: -10 °C – 45 °C
Operating air humidity: ≤ 90 % RH
Battery life: 50,000 presses



Device Description

The smart scene switch is a smart device that enables you to easily control the scenes in your smart household. Using the scene switch, you can quickly and easily change the settings for your lightning, temperature and other devices in the room.

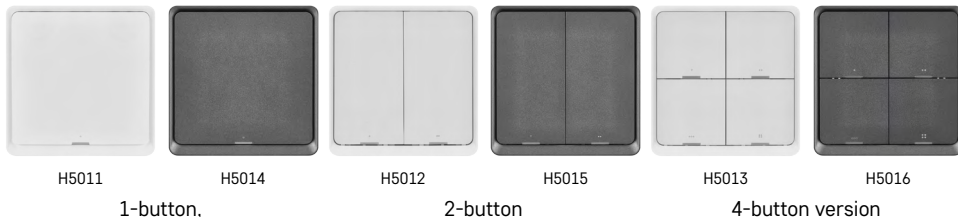

The choice of the number of buttons depends on the customer's needs. 1 button is capable of recognising 3 types of presses: a short press, a double press and a long press (> 1 second). Each type of press can be assigned a different function.

This allows the 1-button switch to control 3 functions, the 2-button switch 6 functions and the 4-button switch up to 12 functions.



Installation and Assembly

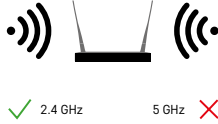

Attention

The smart scene switch only communicates with a ZigBee gateway, such as EMOS H5001. The ZigBee gateway provides connection and communication between smart ZigBee devices in the household, allowing them to be controlled and managed through a centralised interface. This enables automation, monitoring and centralised control over your smart devices.

Installation

Since the device is powered solely by a battery, it can be mounted onto a wall or attached anywhere within the range of the ZigBee network using the enclosed double-sided tape. The switch can, therefore, be placed on a table, a wall or mounted in place of a standard light switch.

The back cover of the device is also designed for mounting into a standard junction box used for traditional light switches. Thanks to pre-defined openings, mounting the switch is quick and easy. However, the junction boxes that the switch can be mounted onto may have a different diameter. In that case, you can drill holes into the back cover of the smart switch to fit the given junction box.

Inserting Batteries

The device is powered by a CR2430 battery, which is not included. The battery must be inserted into the slot located under the rear cover of the device.

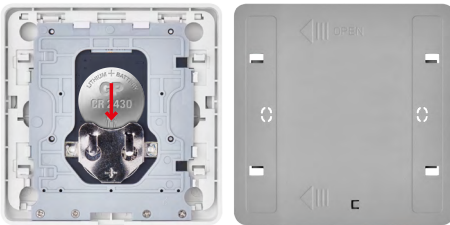
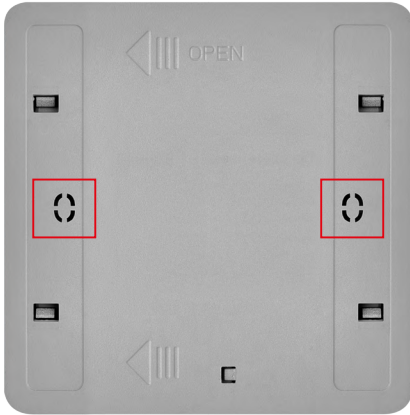

Pairing with the App

Installing the EMOS GoSmart App



- The app is available for Android and iOS on Google Play and App Store.
- Download the app by scanning the QR code.

Steps in the EMOS GoSmart Mobile App

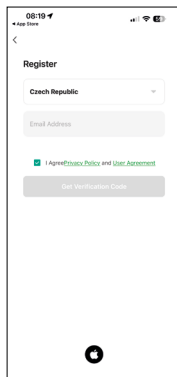
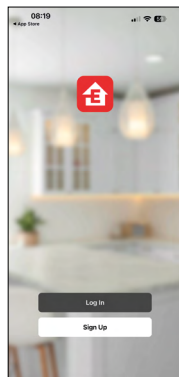
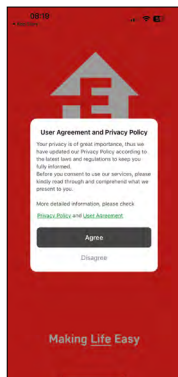

1. Open EMOS GoSmart and confirm the privacy policy by tapping Agree.
2. Choose Sign Up.
3. Enter a valid e-mail address and choose a password.
4. Confirm that you agree to the privacy policy.
5. Choose Sign Up.

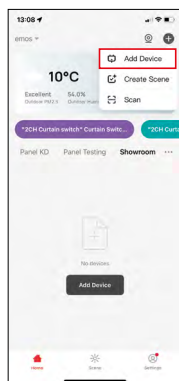
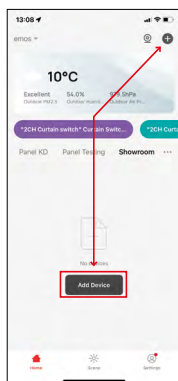

6. Choose Add Device.



7. Choose the GoSmart product category and choose the corresponding switch.
8. Choose which ZigBee gateway you want to connect the switch to.



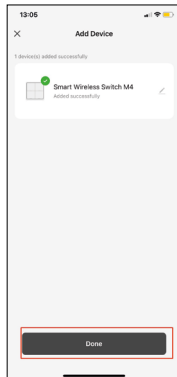
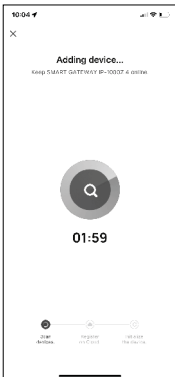

9. Follow the instructions in the pairing manual and reset the device by holding the button for 10 seconds.

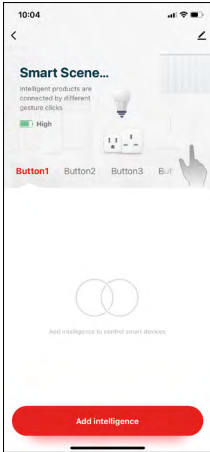

10. The device will be detected automatically. You can now assign a name to the smart scene switch. Then tap Done. Your smart scene switch is now ready to use.



Icons and Indicators

 High	Battery indicator – thanks to the energy-saving ZigBee 3.0 protocol, the battery can last through 50,000 switch presses
Button 1 Button 2 Button 3	Chosen button
	Adds an action for when the button is pressed
	Advanced settings

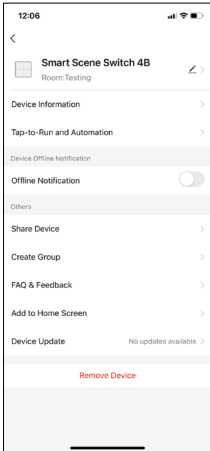

Explanation of Advanced Settings

Device information – basic information about the device

Tap-To-Run and Automation – scenes and automations assigned to the device (however, does not display automations that the button performs on its own)

Offline notification - notification when the device is offline for over 8 hours (e.g. power outage)

Share Device – shares control of the device with another person

Create Group – creates a group of similar devices (most suitable for lights, e.g. for putting all lights in the kitchen in the same group)

Faq and Feedback – frequently asked questions and feedback

Add to Home screen – adds an icon for the device on the phone's home screen

Device Update – updates the device

Remove Device – unpairs the device



Controls and Functions

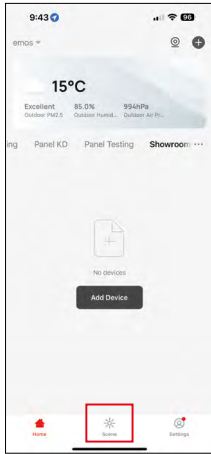

Creating a Scene and Assigning it to a Specific Button

Creating a scene is the first step towards making use of the scene switch. The process is very simple and lets the user get into the role of a „programmer“ with ease.

You can create the scene directly in the settings for the button, or on the home screen of the app.

Each smart device has its specific functions that you as a user can set. The possibilities when creating scenes are nearly endless and their various combinations will help you improve the comfort and safety of your household. We recommend playing around with the settings a bit in this step so that you can take full advantage of the potential of your smart household.

A practical example of creating a scene for an LED lamp:

Function: turning the light on after 1 press

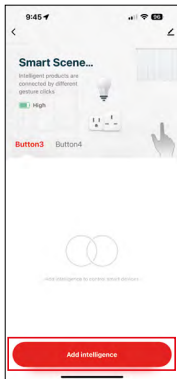

Adding the function to the chosen button via „Add Intelligence“

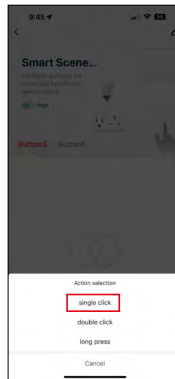

Assigning the action to a single press (click)



Creating a scene

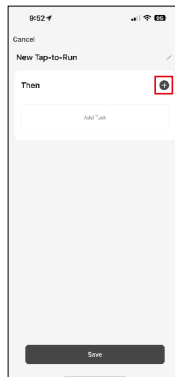

Assigning a task (function) to Tap-To-Run automation



Choosing the device which will perform the function



In this step, you will see all the functions the device can perform. For lights, these are settings such as On/Off, brightness, timer, colour... Other devices may display other, more advanced functions such as turning on heating, setting temperature, opening the blinds and many more. For this example, we will choose the On/Off function. For lights, we also recommend using the „Reverse Switch“ function, which operates as a standard light switch. If the light is off, it will turn it on and vice versa.

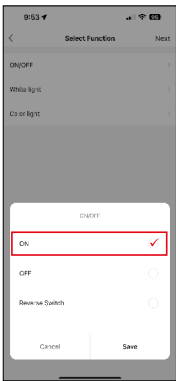

Choose the option



Once you are done with settings, press next and then save the scene

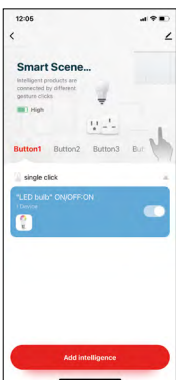

The function is now saved and pressing button no. 1 will turn on the light



Troubleshooting FAQ

The devices are not pairing. What should I do?

- Make sure that the ZigBee gateway is using a 2.4 GHz Wi-Fi network and has a sufficiently strong signal
- Give the app all permissions in the settings
- Check that you are using an up-to-date version of the mobile operating system and the latest version of the app

Who is allowed to use the device?

- The device must always have an admin (owner)
- The admin can then share the device with other people in the household and assign them rights



